Fig. 1

- ❶ Panel Adaptor with front membrane
- ❷ Gasket
- ❸ Clamp
- ❹ Screw M5x20 ISO 7045 Z
- ❺ Thumb screw M4x16
- ❻ Rotary button with integrated spacer

Panel Adaptor Small Rotary Button

Description

The Panel Adaptor Small is designed for use with the small form factor SPECTOR^{modul} controllers with rotary button (e.g. NRR/NRS 2-50, 2-51; LRR/LRS 1-50, 1-51; TRS 5-52; PRS 50) and enables controller installation in a control cabinet door. It offers the advantage of status visibility and alarm testing without opening the cabinets door. The installed adaptor fulfills the protection class IP65.

Technical data

Materials

- Panel Adaptor: Polycarbonate
- Front membrane: Polyester film
- Gasket: Cellular rubber
- Clamp: Galvanized steel
- Screw: Galvanized steel
- Thumb screw: Polyamid 6.6
- Rotary button: Rubber / Polypropylene

Weight

- approx. 0.066 kg (including screws, clamps and gasket)

Admissible ambient conditions

- Ambient temperature: 0 to 55°C
- Transport temperature: - 20 to + 80°C
- Storage temperature: - 20 to + 70°C
- Relative humidity: max. 95%,
no moisture condensation

Protection

- IP65 when mounted as shown in the installation section

Admissible installation positions

- For indoor use only

Parts

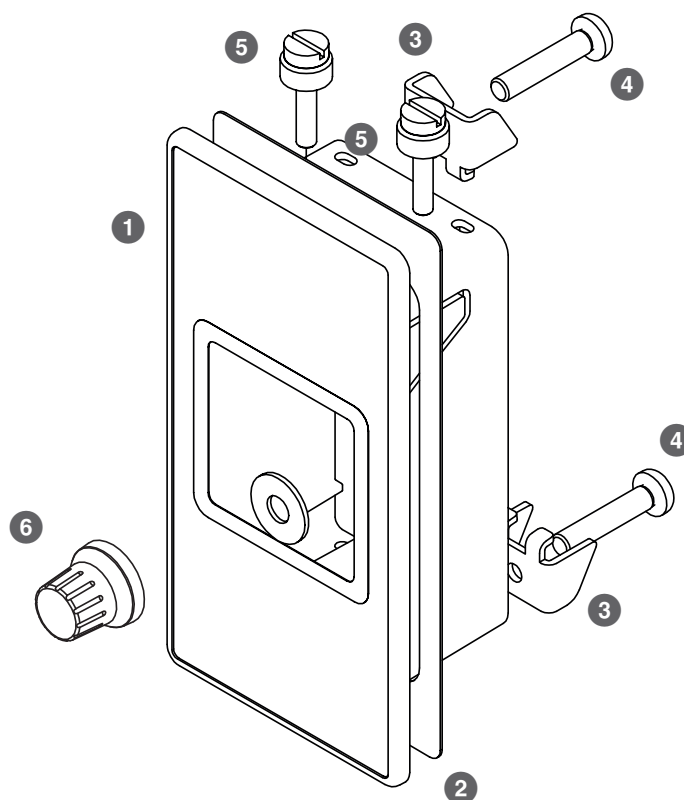
Fig. 2

Dimensions (approximate) in mm

Panel Cut Out

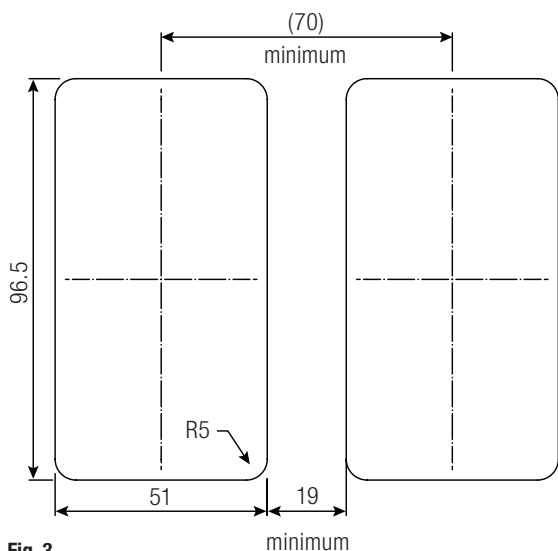

Fig. 3

Panel Adaptor

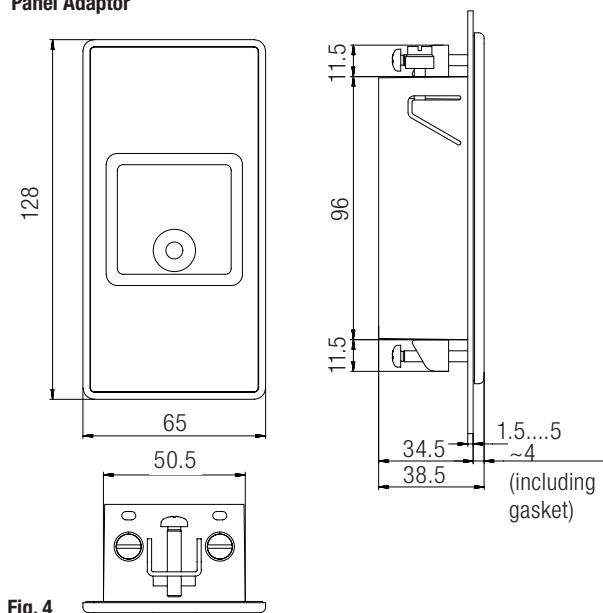

Fig. 4



Note

The recommended minimum spacing between panel cut outs is 19 mm.



Note

When installed in tight enclosures without pressure compensation use a "pressure compensation element" to equalize pressure differences caused by temperature changes. Without pressure compensation moisture can be sucked in and the IP protection can not be guaranteed.

Dimensions of a controller assembled into Panel Adaptor

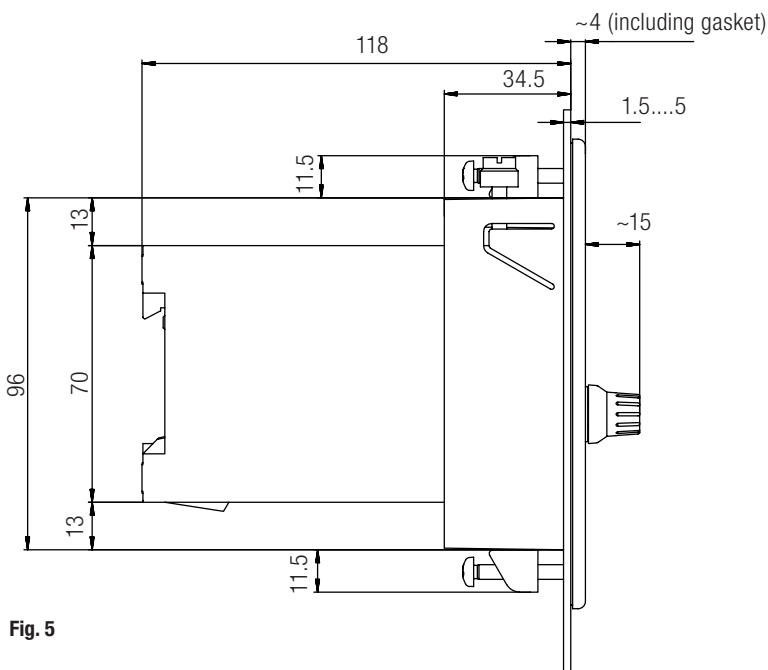
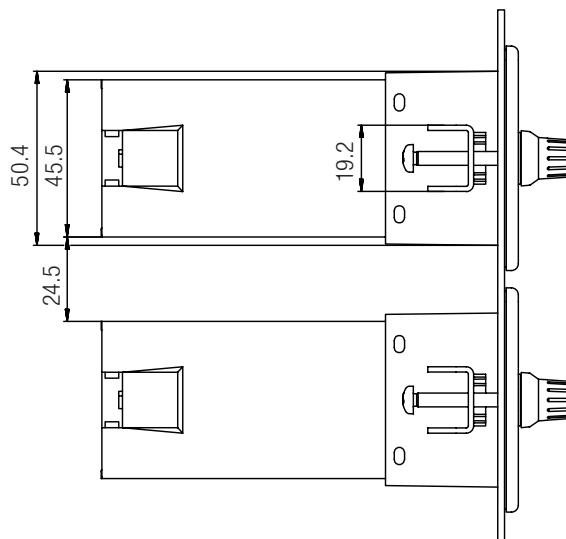

Fig. 5



Installation

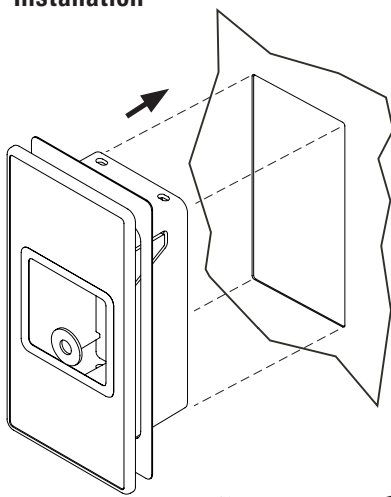

Fig. 6

Pozidrive PZ2

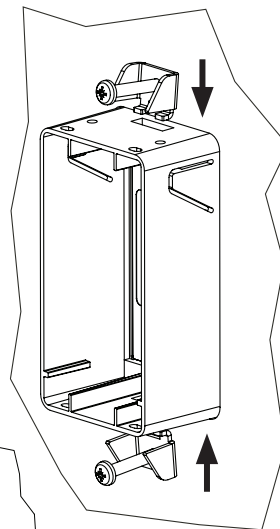

Fig. 7

- 1 Remove rotary button. If necessary use a flat screwdriver to lift the button.
- 2 Adjust the shaft as shown: flat side shows upwards.

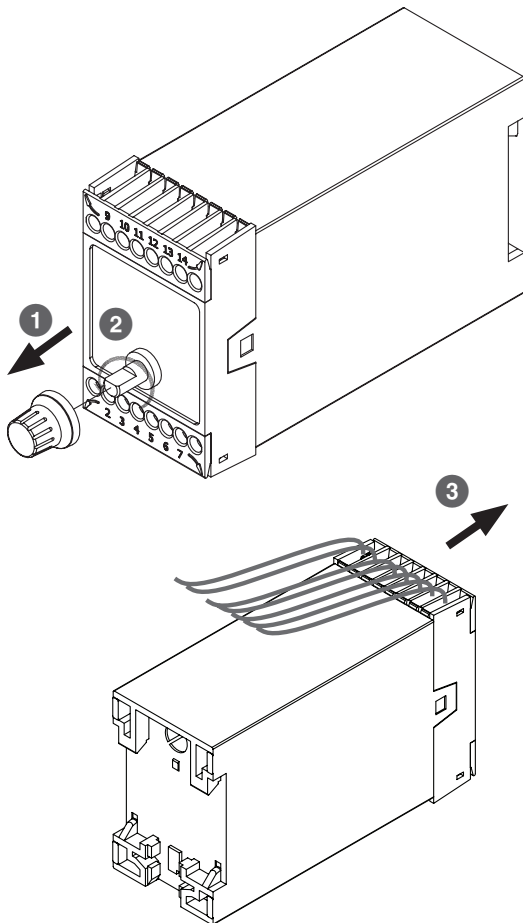
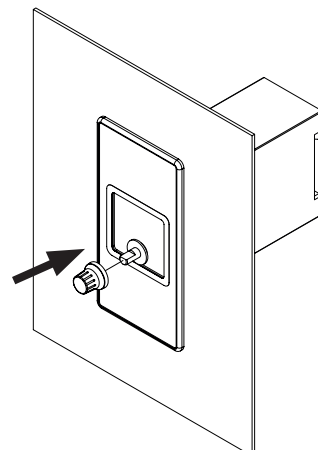

Fig. 8

Holes are provided for cable ties to secure wiring to adaptor once assembled



Note

The safety section of the controllers installation manual must be read before the installation of the panel adaptor is attempted.



Note

Torque for clamp screws: 0.3 - 0.4 Nm
Do not over tighten causing excessive bending of the adaptor.



Note

If vibration is expected during transportation or operation of the assembled unit, use a locking medium for the clamp screws (e.g. Loctite low-strength).



Note

Ensure that the wires are not trapped or damaged when the thumb screws are tightened and do not over tighten causing excessive bending of the screws, controller housing or adaptor.



Note

The controller must be wired before it is inserted into the adaptor.



Note

Insert the controller carefully under slight rotation. Keep the shaft aligned with the hole to avoid front membrane damage.



Note

Use rotary button with integrated spacer supplied with the adaptor.

Panel Adaptor Small Rotary Button

- 1 Remove rotary button. If necessary use a flat screwdriver to lift the button.
- 2 Adjust the shaft as shown: flat side shows upwards.



Note

Remove the controller carefully under slight rotation. Keep the shaft aligned with the hole to avoid front membrane damage.

Supply in accordance with our general terms of business.

Removing the controller from the Panel Adaptor

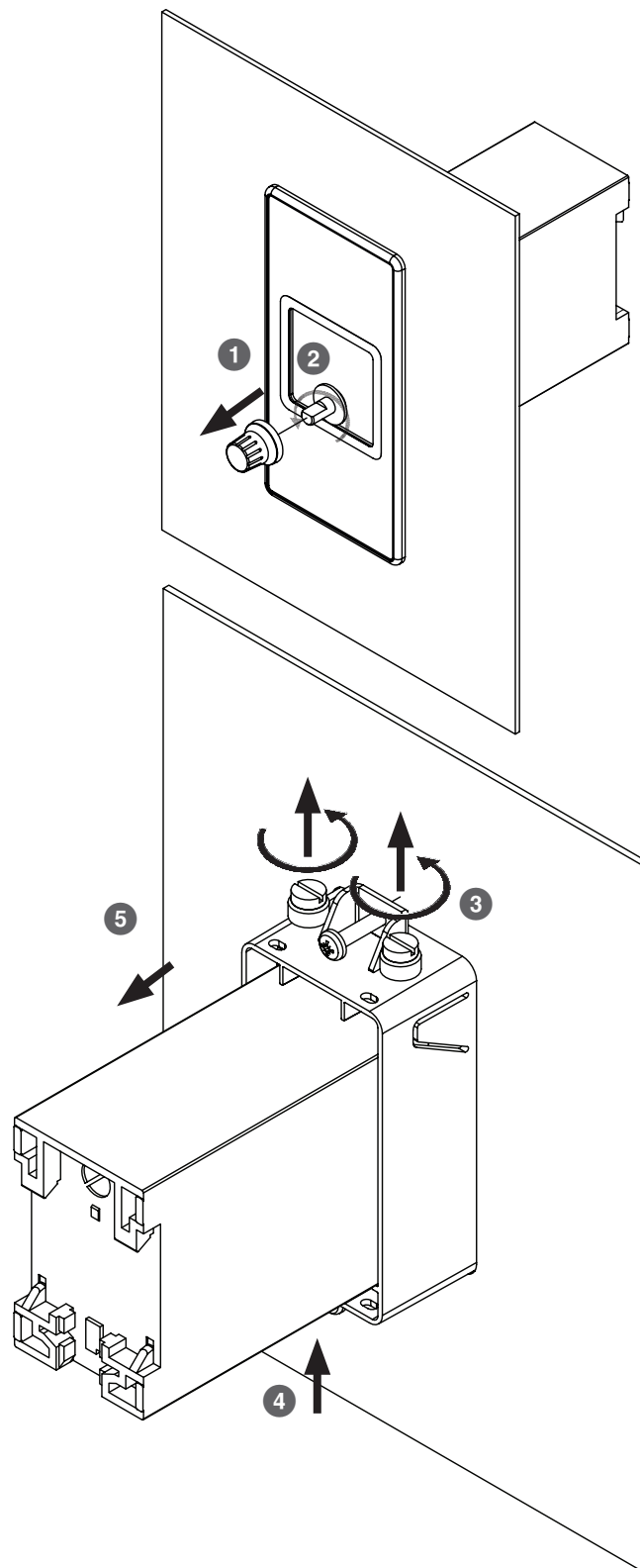

Fig. 9

Maintenance

The equipment must be inspected and cleaned regularly to prevent the build-up of dust on the product. The adaptor should only be wiped with a damp cloth using non aggressive cleaning agents. The front membrane and gasket should be regularly inspected for damage.

GESTRA AG

Münchener Straße 77, 28215 Bremen, Germany
Telefon +49 421 3503-0, Telefax +49 421 3503-393
E-mail info@de.gestra.com, Web www.gestra.de

